



For colleagues submitting from outside the USA:

We accept uroliths from non-infectious Dogs, Cats, Rodents, Amphibians and Reptiles **Samples from livestock, humans, primates, most zoo animals and some wildlife are not accepted******

SHIPPING: Send through a shipping company that complies with USA Customs inspections. **All charges including shipping, duties, customs and taxes must be paid by the shipper (DDP duties and delivery paid by shipper).** The Minnesota Urolith Center is not responsible for package transport charges.

REQUIRED DOCUMENTS: Packages must contain appropriate paperwork from the shipper.

[Guidelines: Animal Products That Do Not Require An Import Permit](#)

A USDA import permit will not be required for feline or canine origin material that has not been inoculated with or exposed to any livestock or poultry disease agent. **In order to facilitate correct identification of the shipment and to ensure timely delivery, USDA, AHPIS, VS recommends that the following documentation accompany each shipment:**

1. **A written statement identifying the material and naming the animal species,**
2. **A written statement confirming that the material does not contain any other animal derived material (i.e., does not contain any livestock or poultry origin material).**
3. **A written statement confirming that the material was not derived from feline or canine species which were inoculated with or exposed to any infectious agents of USDA agricultural concern.**

USDA, APHIS, VS recommends that **this document be supplied on foreign producer/shipper letterhead, with the letterhead containing the physical address of the foreign producer/shipper.** USDA, APHIS, VS further recommends that the document, written in a clear and concise manner, accompany each shipment, and be presented as a separate document for review by the DHS, CBP Officers at the U.S. port of arrival. We do not recommend that the foreign producer/shipper place this document inside the shipping containers (**place in envelope on outside of shipment**).

COUNTRY SPECIFIC REGULATIONS: Information provided is for USA import only. Your local shipping company can provide instructions on export requirements for exempt animal specimens from your county.

PACKING: Follow required packing/shipping regulations [for Biological Substance Category B exempt animal specimen \(example below\)](#). [Label submission](#) container with clinic and owner information. ****Submit samples dry, not in urine, blood, liquids, or preservatives****

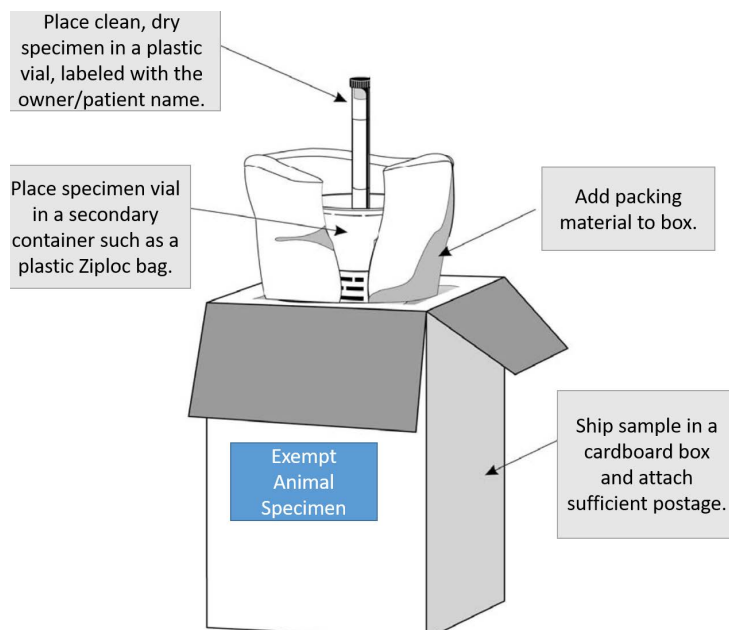

[How to package Video](#)

